



Quick Start Guide



For additional information, please refer to the *Wraptor™ User's Guide*

www.bradyid.com/wraptor



Introduction

About the Quick Start Guide

This guide is designed as a quick reference only. For detailed information, please refer to the *Wraptor User's Guide*. A printable version of the *Wraptor User's Guide* is available in Adobe PDF format from the Wraptor CD Installation Menu. See ***Insert the Wraptor Utilities CD-ROM*** on page 5 of this guide.

For information on using *LabelMark* software, please refer to the *LabelMark User's Guide*.

Registration

Please register your Wraptor online at www.bradyid.com/productregistration. Your Wraptor must be registered within 30 days to validate warranty and machine support.

System Requirements

Following are the *recommended* requirements for the computer on which you will install and run *LabelMark*, the *File Management Utility* and the *Wraptor Printer Driver*:

- Intel® Pentium® processor (*minimum 66 MHz 486DX2*)
- Operating system:
 - Microsoft® Windows® 2000 with Service Pack 1
 - Microsoft® Windows® NT with Service Pack 6a
 - Microsoft® Windows® XP
- Microsoft® Internet Explorer 5.01
- 64MB of RAM (*minimum 16 MB of RAM*)
- 100 MB of available hard-disk space
- 16-bit or greater video display card
- 800x600 or greater monitor resolution
- CD-ROM Drive

Regulatory Information

CAUTION: The user is cautioned that any changes or modifications not expressly approved by Brady Worldwide, Inc. could void the user's authority to use the equipment.

Note: This equipment has been tested and found to comply with the limits for a Class A digital device, pursuant to part 15 of the FCC Rules. These limits are designed to provide reasonable protection against harmful interference when the equipment is operated in a commercial environment. This equipment generates, uses, and can radiate radio frequency energy and, if not installed and used in accordance with the instruction guide, may cause harmful interference to radio communications. Operation of this equipment in a residential area is likely to cause harmful interference in which case the user will be required to correct the interference at his own expense.

This Class A digital apparatus meets all requirements of the Canadian Interference-Causing Equipment Regulations.

Cet appareil numérique de la classe A respecte toutes les exigences du Règlement sur le matériel brouilleur du Canada.

This is a Class A product. In a domestic environment this product may cause radio interference, in which case the user may be required to take adequate measures.

Éste es un aparato de la clase A y podría provocar interferencias de radio en un entorno doméstico, en cuyo caso el propietario tendría que tomar las medidas oportunas.

Il s'agit d'un produit de Classe A. Dans un environnement domestique, ce produit est susceptible de provoquer des interférences radio, auquel cas l'utilisateur peut se voir obligé de prendre les mesures appropriées.

Safety

This section contains safety information necessary for the safe operation of the *Wraptor*. Be sure to read this section prior to setting up or operating the unit.

Always be sure to adhere to the safety standards regulating your operating environment. Also adhere to the following safety rules included in or in addition to your specific standards:



WARNING: Do not wear loose clothing—such as long sleeves or scarves—that could become caught in the unit.



CAUTION: Keep areas around the unit clean at all times.

Electrical Safety



CAUTION: Connect the three-conductor plug to a North American standard 120 VAC outlet. Make sure the outlet is **grounded**.



WARNING: Turn off power and unplug the unit before performing any service or maintenance on the *Wraptor*.

Automatic Stops

The *Wraptor* employs the following automatic safety stops:

Front Door

A plastic cover protects the jaws of the unit. The unit is designed to automatically stop all moving parts when the plastic cover is open.

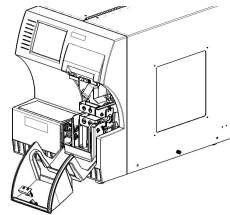

Side Door

The unit is designed to automatically stop all moving parts when the side door is opened. You may view the materials in motion through the plastic viewing window when the side door is closed.

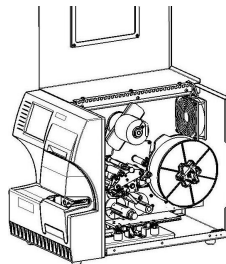

WARNING: Do not attempt to disable the front or side door auto-stop mechanisms as doing so may cause injury.

Installation and Preparation

Initial Setup

This section provides information on installing and preparing the *Wraptor* for initial use. Follow these steps before creating and printing labels:

Unpack and Setup the Wraptor Unit

Step 1. Unpack



WARNING: The Wraptor weighs 80 lbs. Get assistance to lift!



NOTE: Make sure the Wraptor boxes remains in the upright position at all times. Do not lay the box on its side.

1. The Wraptor comes in a cardboard box banded to a palette. Cut the band.
2. Lift the top cover off the base.
3. Lift the Wraptor out of the protective foam surrounds and place the unit on a flat, level surface.



NOTE: Be sure to place the *Wraptor* unit on a flat, level surface that can easily support 125lbs.



NOTE: Save all packaging materials! These will be needed if you must ship the Wraptor.

4. Remove the following additional items from the Wraptor box:
 - Wraptor Utilities CD containing the following:
 - Print Driver
 - File Management Utility (FMU) software
 - *Wraptor™ User's Guide*
 - *Wraptor™ Programmer's Guide*
 - Link to Product Registration
 - LabelMark CD
 - Power Cord
 - USB ConnectorThe following items come pre-installed in the Wraptor:
 - Label Material (1" x 1.5")
 - Ribbon
 - CompactFlash Memory Card

Step 2. Remove protective inserts

1. Remove protective foam insert from the wrapper.

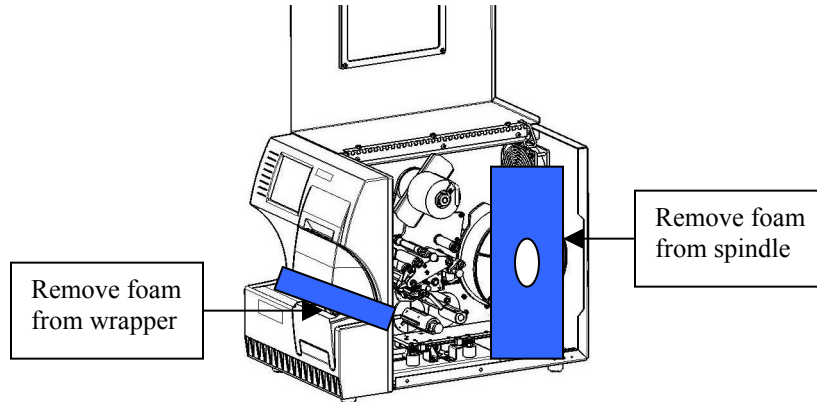

2. Open the side door, and remove protective foam covering from the material spindle.
3. Remove foam insert from underneath the right side of the printer frame. To do this:
 - Remove the material roll from the spindle.
 - Remove the foam insert.

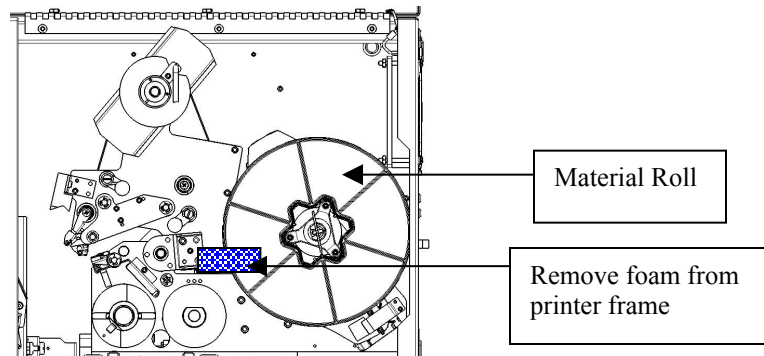

- Replace the material roll onto the spindle. Ensure that the touch memory cell is *securely* positioned in the reader clip. See *Put Label Material on Spool* on page 8 of this guide for instructions.
4. Remove the stabilizer block from underneath shuttle base plate. To do this:

- Remove the ribbon from the feed spool. See *Load the Printer Ribbon on page 10 of this guide for instructions.*

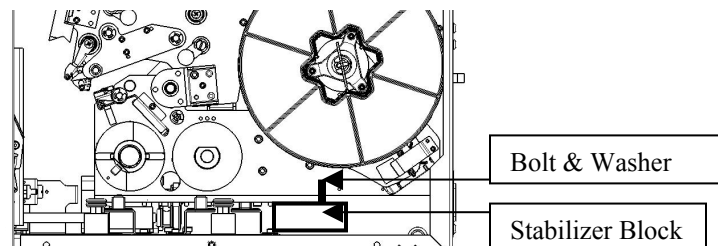

- Remove the stabilizer block bolt and washer.
- Remove the stabilizer (white) block.
- Replace the ribbon onto the feed spool.
- Close the side door.

Load Software on Your Computer and Connect Wraptor

The Wraptor Utilities CD-ROM and *LabelMark* CD contain the applications necessary to create, print and manage your labels and label files:

- **LabelMark**—*LabelMark* allows you to create and format labels for a variety of industrial applications.
- **File Management Utility**—This application allows you to transfer label files between your computer, the *Wraptor* and the *Wraptor's* CompactFlash Memory Card.
- **Wraptor Printer Driver**—The printer driver allows your computer to print labels to the *Wraptor* unit.

Step 1. Install *LabelMark* on Your Computer

1. Insert the *LabelMark* CD into your CD drive. The install screen appears. If the install does not start automatically, select **Start** → **Run**, type **D:\setup.exe** and click **OK** (replace *D:* with your CD drive.)
2. Click **Install LabelMark**.
3. Follow the prompts on your screen.



NOTE: Refer to the *LabelMark User's Guide* for more information.

Step 2. Insert the Wraptor Utilities CD-ROM

Insert the enclosed Wraptor Utilities CD-ROM into your computer's CD Drive. The Wraptor Installation Menu appears:



NOTE: If the CD does not start automatically: Click **Start** → **Run**, then type **D:\CDSETUP.exe** and click **OK** (where *D:* is your CD-ROM drive).

Step 3. Install the *File Management Utility*

Click **Install File Management Utility** on the *Wraptor Installation Menu* and follow the screen prompts.

Step 4. Install the *Wraptor Printer Driver*

1. Click **Install Wraptor Printer Driver** on the *Wraptor Installation Menu*.
2. Select the language and click **OK**.
3. Select **USB** as the port you want to install from the list of *Available ports* and click **OK**.



NOTE: The *Quick Start* describes the USB installation. Refer to the *User's Guide* for Serial or Ethernet (TCP/IP) instructions.

4. Next a dialog will prompt you to reboot the computer.

Select **Yes** and **Finish** to reboot the computer and complete the installation.

Step 5. Connect Unit to Power

1. Obtain a suitable alternate power cord if outside of North America (see the *Wraptor User's Guide*).
2. Connect the power cord to the back of the *Wraptor* and into the outlet.



CAUTION: Make sure the outlet is **grounded**.

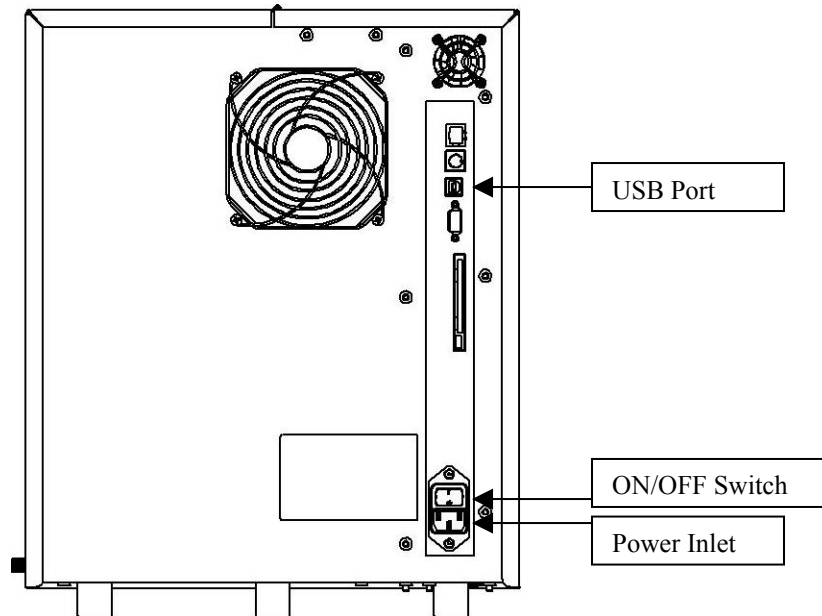

Step 6. Power Unit ON

If you haven't already done so, power on the *Wraptor* unit. The touch screen automatically initializes and the *Wraptor Control Panel* screen appears. Refer to The *Wraptor Control Panel* section of the *Wraptor User's Guide* for details.

Step 7. Configure for USB Operation

1. Plug the provided USB cable into the computer and the *Wraptor* unit.
2. On the *Wraptor Control Panel*:
 - Select the **CONFIG** tab.
 - Select **USB** as the *Connection Type*.

The *Wraptor* is ready to print and wrap via the USB connection.

Load Label Material

Follow the steps below to load label material in the *Wraptor* unit. Use the following material path diagram as your guide:

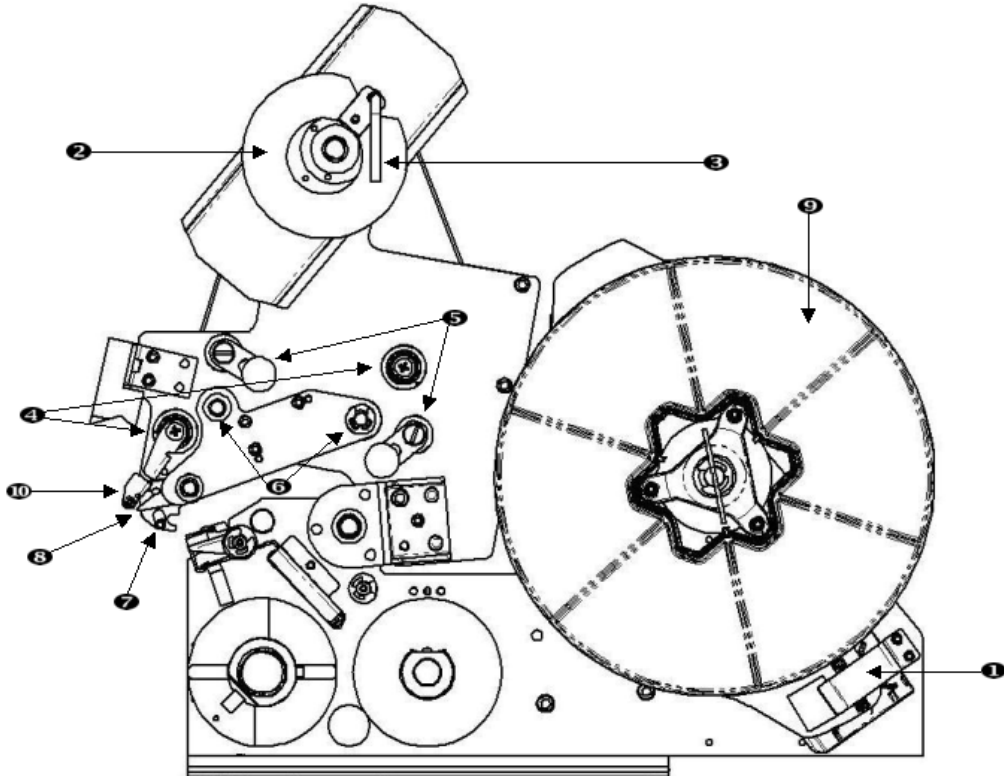

- | | |
|-------------------------------|---------------------|
| 1. Material Reader | 6. Drive Rollers |
| 2. Label Take-Up Spool | 7. Optic Sensor Bar |
| 3. Label Take-Up Spool Handle | 8. Peel Plate |
| 4. Guide Rollers | 9. Label Roll |
| 5. Nip Rollers | 10. Label Deflector |

Step 1. Initiate Label Load in Control Panel

From the *Wraptor Control Panel*, select **SETUP → LOAD LABELS**.



NOTE: The print/wrap assembly automatically slides back for easy access during the material loading process.

Step 2. Open the *Wraptor* Unit

Lift the side door of the *Wraptor* unit.



NOTE: Refer to the material threading diagrams located on the inside of the side door.

Step 3. Open Rollers



**WARNING: The take-up reel motor is active when the side door is open.
KEEP FINGERS AND OTHER BODY PARTS AWAY**

- Open the take-up spool handle (turn counter-clockwise).
- Open the nip rollers:
 - Open the left roller by swinging it up and pushing in.
 - Open the right roller by swinging it down and pushing in.

Step 4. Remove Previously Used Material

If material is currently loaded, remove it.

Step 5. Put Label Material on Spool

- Place the label roll on the spool.
- Turn flange counter-clockwise to rotate the label roll so the touch memory cell is *securely* positioned in the reader clip.

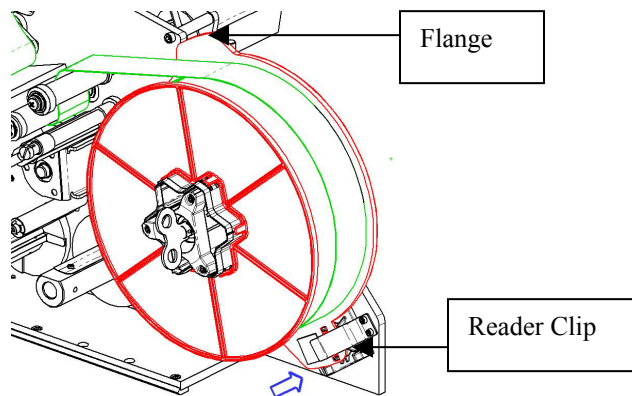

Step 6. Thread Labels

1. Thread the label:
 - Over the first guide roller
 - Under the first drive roller and over the first nip roller
 - Above the optic sensor bar

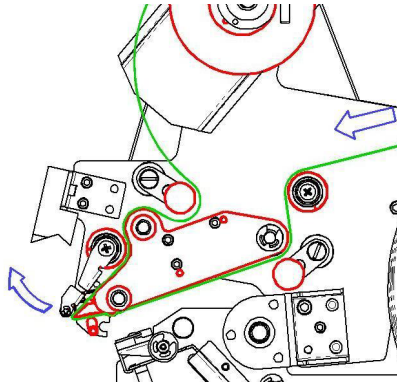

- Lift the label deflector and thread the material between the peel plate and deflector. Continue to thread the label:
 - Under the second guide roller and over the second drive roller
 - Under the second nip roller
2. Thread Labels Under take-up Bar
 - Thread the labels under the take-up bar.
 - Close the take-up spool handle (turn clockwise).
 - Rotate the take-up spool to remove slack.
 3. Adjust Guide Rollers
 - Be sure labels are up against the far side of the rollers.
 - Position guide rings snug to the label liner.
 4. Close Nip Rollers
 - Pull out and snap closed.

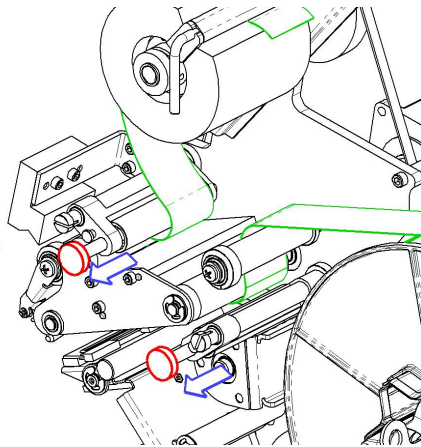

5. Tighten With Key
 - Turn spool key clockwise to remove slack.

Step 7. Feed a label

- Press the **Feed Label** button on the *Wraptor Control Panel* until a label dispenses.
- Remove the dispensed label.

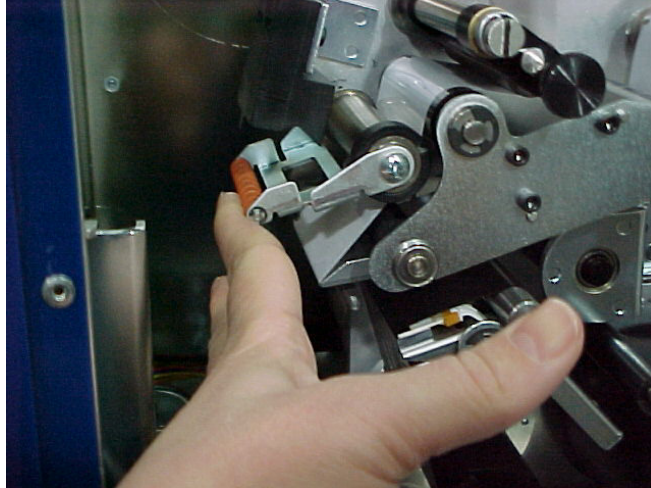

IMPORTANT: Be sure to remove the dispensed label. Failure to do so will jam the print mechanism.

Step 8. Close the Wraptor Unit

Close the side door of the *Wraptor* unit. Make sure that the door is closed securely.

Step 9. Place the *Wraptor* online

Press **Online** on the *Wraptor Control Panel* to prepare the *Wraptor* to print.

This shuttles the print/wrapper mechanism forward and tilts the print head closed.

Load the Printer Ribbon

Follow the steps below to load a ribbon in the *Wraptor* unit:

Step 1. Initiate Ribbon Load in *Control Panel*

From the *Wraptor Control Panel*, select **SETUP → LOAD RIBBON**.

Step 2. Open the *Wraptor* Unit

Lift the side door of the *Wraptor* unit.

Step 3. Remove the Old Ribbon, if necessary

Use the following ribbon path diagram as your guide:

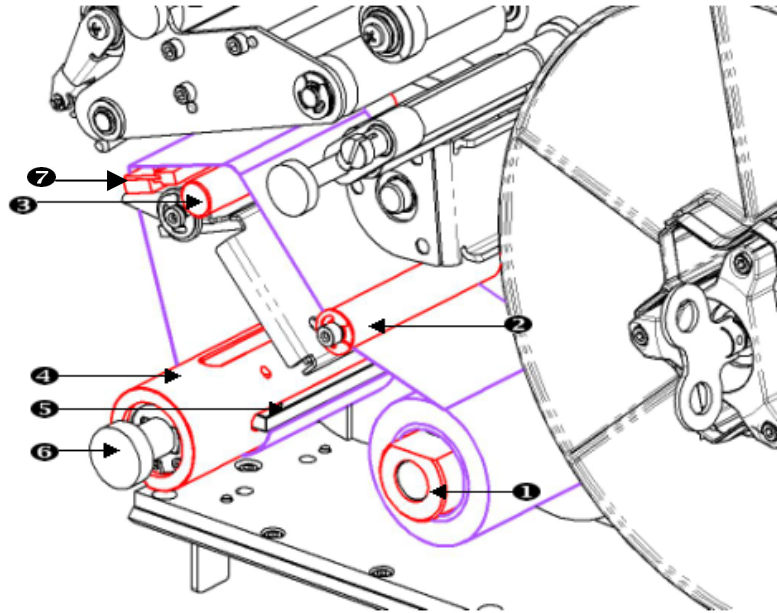

- | | | |
|-----------------|------------------|-----------------------|
| 1. Feed Spool | 3. Guide Bar | 5. Clip |
| 2. Guide Roller | 4. Take-up Spool | 6. Take-up Spool Knob |
| | | 7. Printhead |

- Cut the ribbon between the guide bar and take-up spool.
- Hold the edge of the take-up spool while turning the knob clockwise until it stops.
- Pull the take-up spool knob to remove the used ribbon from the take-up spool and discard.
- Re-engage the take-up spool by pushing it in all the way until the knob auto-rotates back to its original position. **Failure to re-engage the take-up spool will make it difficult to remove the old ribbon next time!**
- Remove remaining ribbon, if any, from the feed spool.
- Use tape to secure the end of the ribbon roll.

Step 4. Thread Ribbon

- Place ribbon roll on the feed spool.
- Thread the ribbon under the guide roller and over the guide bar and printhead.
- Feed ribbon under the clip as shown below until approximately ¼” of ribbon is past the clip.

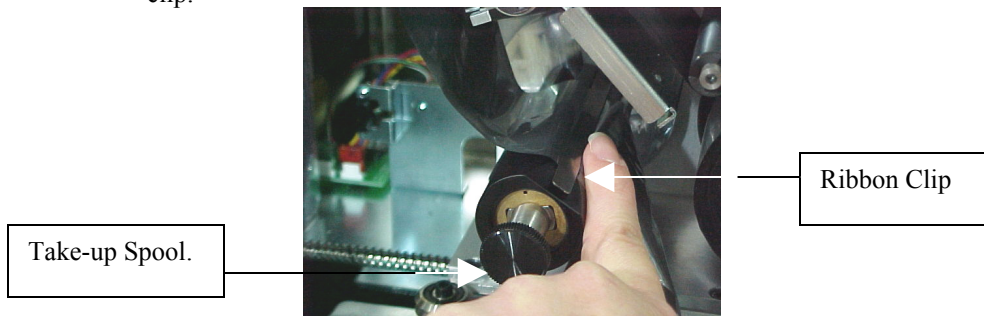

- Turn the take-up spool knob counter-clockwise until the ribbon is wrapped around the take-up spool several times to ensure that it won't unravel.

Step 5. Close the Wraptor Unit

Close the side door of the *Wraptor* unit.

Step 6. Place the *Wraptor* online

Press **Online** on the *Wraptor Control Panel* to prepare the *Wraptor* to print.

General Operation

This section provides an overview of the *Wraptor* operation process.

Creating, printing and wrapping labels

The *Wraptor* works in conjunction with your computer and software applications included with the unit. The process flow is as follows:

On your computer:

1. Design labels on your computer using Brady's LabelMark software.
2. "Print" your completed labels to the Wraptor printer with the Print command.

On the Wraptor printer:

3. *Open* the print file you want to work with on the *Control Panel's File* tab.
4. Physically insert a cable/wire into the *Wraptor* jaws to print/wrap or wrap a label.



**WARNING: The wrapper mechanism contains
HAZARDOUS MOVING PARTS
KEEP FINGERS AND OTHER BODY PARTS AWAY**

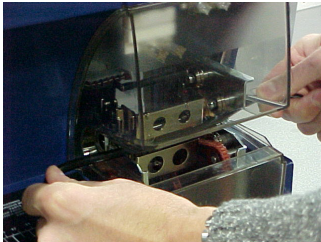

- Be sure to hold the wire straight and tight during the wrapping process.

- Do not use wire jackets with greasy coatings or the label will not wrap



CAUTION: The maximum wire diameter that can be used in Wraptor™, INCLUDING the wire's outer jacket, is 0.600". Exceeding this diameter will jam and potentially damage the machine. If a wire diameter less than 0.060" (including wire jacket) is used, the label will not wrap successfully.